

K-Pattern Semi Rotary Hand Pump

The world's most successful hand pump

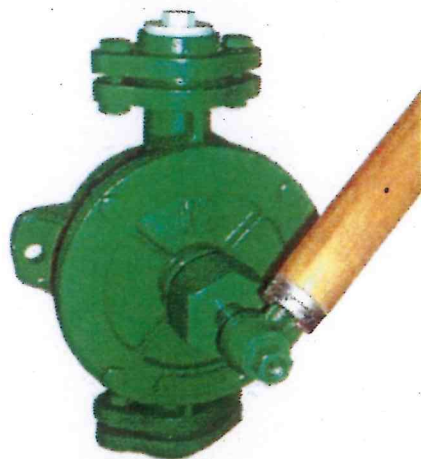

Specification

Generally in accordance with BS.1208 Type A (now withdrawn). Double acting, the pumps are made of iron with internal parts of brass and handles of wood, steel shafts and soft graphite seals. Simple and robust, they can be used for pumping many clean liquids such as diesel, lube oil, paraffin, petrol, light chemical solutions, water and hot liquids (up to 80°C).

Applications

Ideal for bowzers, generating sets, fuel transfer, marine use, tanks and many others. Operation is by a reciprocating action of the handle. The pump must be mounted with discharge vertically. A foot valve should be used on suction lifts above 2 metres.

Dimensions in millimetres

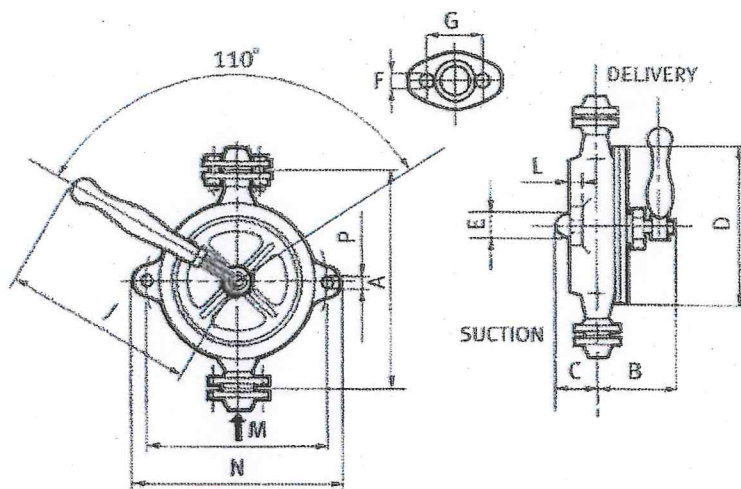

SIZE	K-00	K-0	K-1	K-2	K-3	K-4	K-5	K-7
D	100	135	150	170	200	220	245	288
B	90	140	140	145	170	190	200	273
C	45	55	55	60	62	74	76	80
L	7.5	10	10	10	12	12	12	15
M	98	130	150	170	200	220	240	310
A	110	175	205	230	275	295	320	360
N	120	160	180	200	240	255	275	360
P	7	13	13	13	13	13	13	15
J	220	300	300	360	450	500	600	620
E	32	25	25	30	30	30	35	50
G	-	55	65	75	90	90	100	100
F	-	9.5	9.5	9.5	14	14	14	15
IN/OUT BSP	3/8"	1/2"	3/4"	1"	1 1/4"	1 1/4"	1 1/2"	2"

Technical data (hose sizes are in inches)

TYPE	K-00	K-0	K-1	K-2	K-3	K-4	K-5	K-7
SIZE (INCHES)	3/8"	1/2"	3/4"	1"	1 1/4"	1 1/4"	1 1/2"	2"
WEIGHT KG*	3	5	7	9	12	14	21	35
DOUBLE STROKES PM*	80	65	60	55	50	50	45	40
CAPACITY LPM	7.50	11.50	17.25	22.50	29	43.25	53.50	90
MAX DELIVERY HEAD M	25	25	25	25	22	22	20	15
PIECES PER CASE	30	30	25	15	1	1	1	1
CASE WEIGHT GROSS*	105	165	183	150	17	19	26	40
CASE WEIGHT NETT*	90	150	168	135	12	14	21	35

Suction lift - 7m for all sizes

* This data is approximate